

Strange

STRANGE LOW DRAG HUB KIT INSTRUCTIONS

KIT #
B4152LD - Cobra Jet Mustang

APPLICATIONS
05-20 Mustang
Upgrade For Ford Cobra Jet Mustang

Features and Benefits:

Reduced Drag

- 0.5 inch lbs breakaway torque
(One third of stock Cobra Jet breakaway)

Billet Aluminum Hub housings

- Directly replaces original hubs
- Design assists in friction reduction

Specially Prepared Low Drag Bearings

- Reduced friction between bearings and races
- Lubricated with lightweight low viscosity oil

KIT CONTENTS			
ITEM#	PART#	QTY	DESCRIPTION
1	B4152B	2	Hub - Late Model
2	A1028A	10	1/2-20 x 2.5" Taper head SHCS
3	A1028B	10	1/2" Stripper washer
4	B4152I	2	Bearing sleeve outer
5	B4152C	2	Hub Bearing
6	B4152H	2	Bearing sleeve
7	B4152D	2	Retaining ring for 3" Bore

Installation instructions

1. Raise and support front of vehicle on a level surface using suitable equipment.
2. Remove wheel, stock disc, hub, and caliper from spindle.
3. Replace the stock hub with the hub provided. It comes pre-assembled.
4. Install wheel studs (3) with 1/2" washers (2) in the front hub (1). Use BLUE Loc-tite® on the studs. Torque all studs to 65 ft-lbs.
5. Fix the hub in place using the spindle nut, torquing it to 200 ft-lbs.
6. Slide the rotor over the wheel studs (3) flush to the face of the hub.
7. Attach the caliper to the existing caliper mount.

Note: For full brake kit installation look to B4152WC instructions

FIGURE # 1: Exploded B4152LD Assembly View

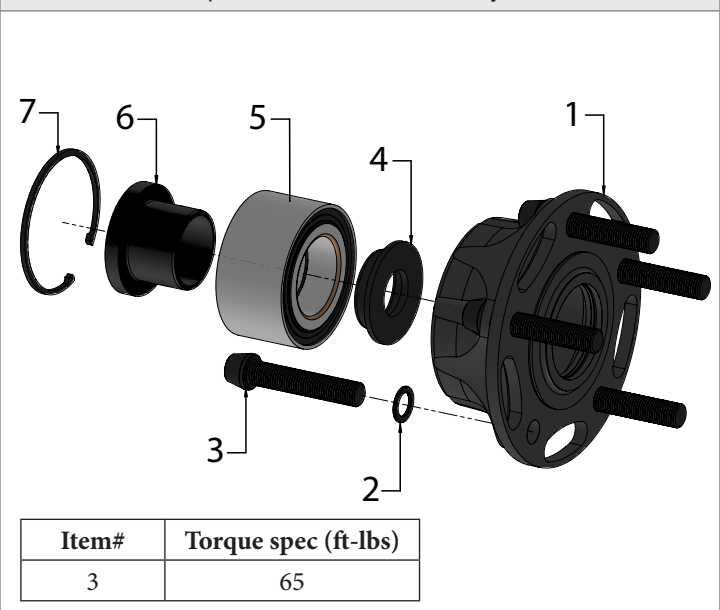

WARNING - RACING IS HAZARDOUS - STRANGE BRAKES ARE FOR LEGAL DRAG RACING ONLY

Disclaimer of Warranty - Purchasers using Strange Engineering racing components and equipment any and all inventory services, purchasers acknowledge that due to differing conditions and circumstances under which all equipment and parts are installed and used, purchasers are not relying on Strange Engineering Co. skill or judgment to select or furnish the proper part or equipment. Purchasers expressly affirm they are relying upon their own skill or judgment to select and purchase suitable goods.

Strange Engineering Co. makes no warranties whatsoever, expressed or implied, oral or written, to purchasers. There is no warranty of merchantability made to purchasers. Strange Engineering Co., further excludes any implied warranty of fitness with respect to racing and equipment, any and all inventory and service.