

Steering Rack Overview

Important notes

- S3442 & S3442-14 Steering racks are to be used for Drag racing **ONLY**
- Designed as a front steer rack (steering arms face towards the front)
- There are 11" and 14" length options available
- If after reading, you have any questions, comments or need to buy old boots, please do not hesitate to call us.

Features

Steering rack and Pinion

- 12 to 1 ratio
- 11" tie rod centers
- 2.620" of rack movement per one revolution of pinion
- 5/8"-36 Serration pinion

Rod Ends

- Stainless steel
- 0.375" spherical ball
- Right hand threads

Body

- 6061-T6511 billet aluminum
- 0.375" bolt holes on 1.312" centers
- Black anodized finish

Rack & Pinion

- 4140 chrome moly
- Hardened

S3442 KIT CONTENTS

ITEM#	PART#	QTY	DESCRIPTION	ITEM#	PART#	QTY	DESCRIPTION
1	S3442O	2	Rod end	10	SST274	1	10-24 X 3/16" Set screw SS
2	S3442E	2	Boot Retainer Plate	11	S3442A	1	Rack and Pinion Box Housing
3	S3442Q	4	Retainer nut	12	S3442G	2	Bushing
4	SST158	4	6-32 X 1/8" Set screw	13	S3442C	1	Pinion
5	P2335	2	3/8-24 Jam nut	14	S3442D	1	Pinion Retainer
6	S3442M	2	Retainer ring	15	H1106U	1	-021 O-ring
7a	S3442B	1	11" Rack	16	S3442H	1	Seal
7b	S3442P	1	14" Rack	17	S3442J	1	Retainer ring - Pinion
8a	S3442U*	2	11" Rack Boot	18	S3442K	1	1/4-28 X 1/4" Set screw
8b	S3442UL	2	14" Rack Boot	19	S3441E	1	Steering box weld bushing
9	S3442F	2	Housing Bushing				

* New Silicone boots as of 03/20 have a compressed diameter of 2.050". Old boots (S3442I) had a 1.800" diameter. If old boots are required call us for more information

S3442 Steering Rack Dimensions

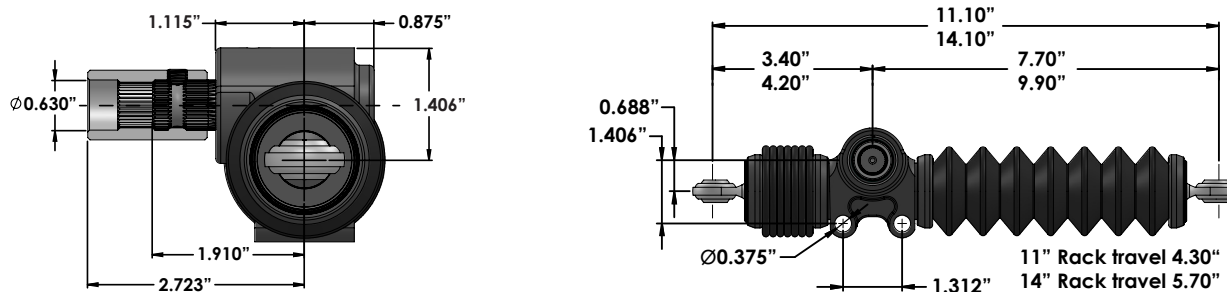

S3442 Steering Rack Assembly Exploded View

